

MILLER®
ICE-25C®
Spectrum®375

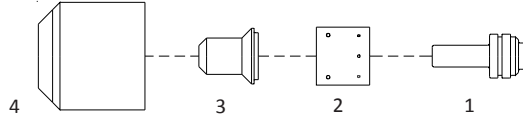

No.	Ref.	Code	Description	No.	Ref.	Code	Description
1	176655	52631	Electrode	3	176656	51431	Tip ø 0.75 - .030
2	176657	60036	Swirl Ring	4	176658	60300	Retaining cap

MILLER®
ICE-27C®
Spectrum®375 CutMate®

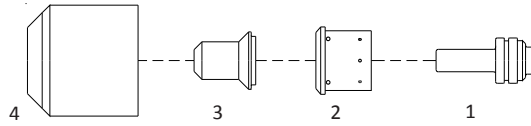

No.	Ref.	Code	Description	No.	Ref.	Code	Description
1	176655	52631	Electrode	3	176656	51431	Tip ø 0.75 - .030
2	202809	60038	Swirl Ring	4	202808	60300	Retaining cap

MILLER®
ICE-50C®
Spectrum®701

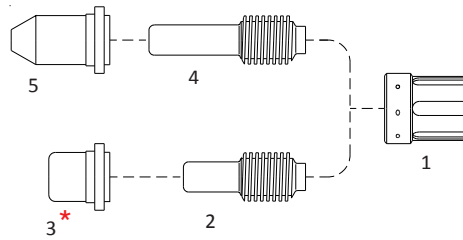

*** while stocks last**

No.	Ref.	Code	Description	No.	Ref.	Code	Description
1	177886	60046	Swirl Ring	4	180340	52635	Extended electrode
2	177875	52634	Electrode	5	177876	51435	Extended tip
3*	177890	51433*	Tip				

MILLER®
ICE-55C® / ICE-55CM®
Spectrum®625
Spectrum®2050

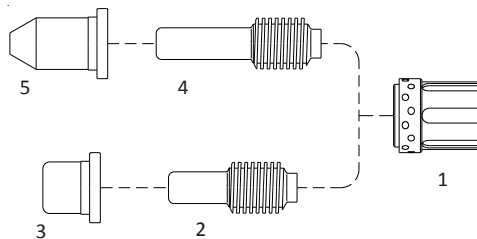

No.	Ref.	Code	Description	No.	Ref.	Code	Description
1	192049	60047	Swirl Ring	4	192048	52635	Extended electrode (replaces 180340)
2	192047	52634	Electrode (replaces 177875)	5	192056	51436	Extended tip 55A
3	192051	51434	Tip		192052	51437	Extended tip 35A

Replacement parts suitable for:

MILLER® APT 5000/7000®
OTC® D-7000 - A50/A70®

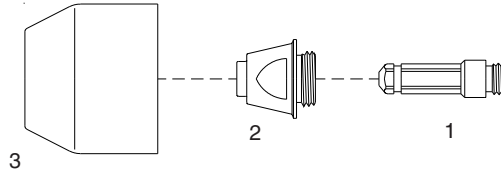

while stocks last

No.	Ref.	Code	Description	No.	Ref.	Code	Description
OTC® D-7000 - A50/A70®				MILLER® APT 5000/7000®			
1	H669G11	52740	Electrode	1	123-899	52740	Electrode
2	H669G06	51255	Tip S 50A	2	123-898	51255	Tip ø 1.0 50A
	H669G05	51256	Tip H 70A		134-338	51256	Tip ø 1.2 70A
3		80058	Shield cap A50/A70				

OTC®
D - 12000

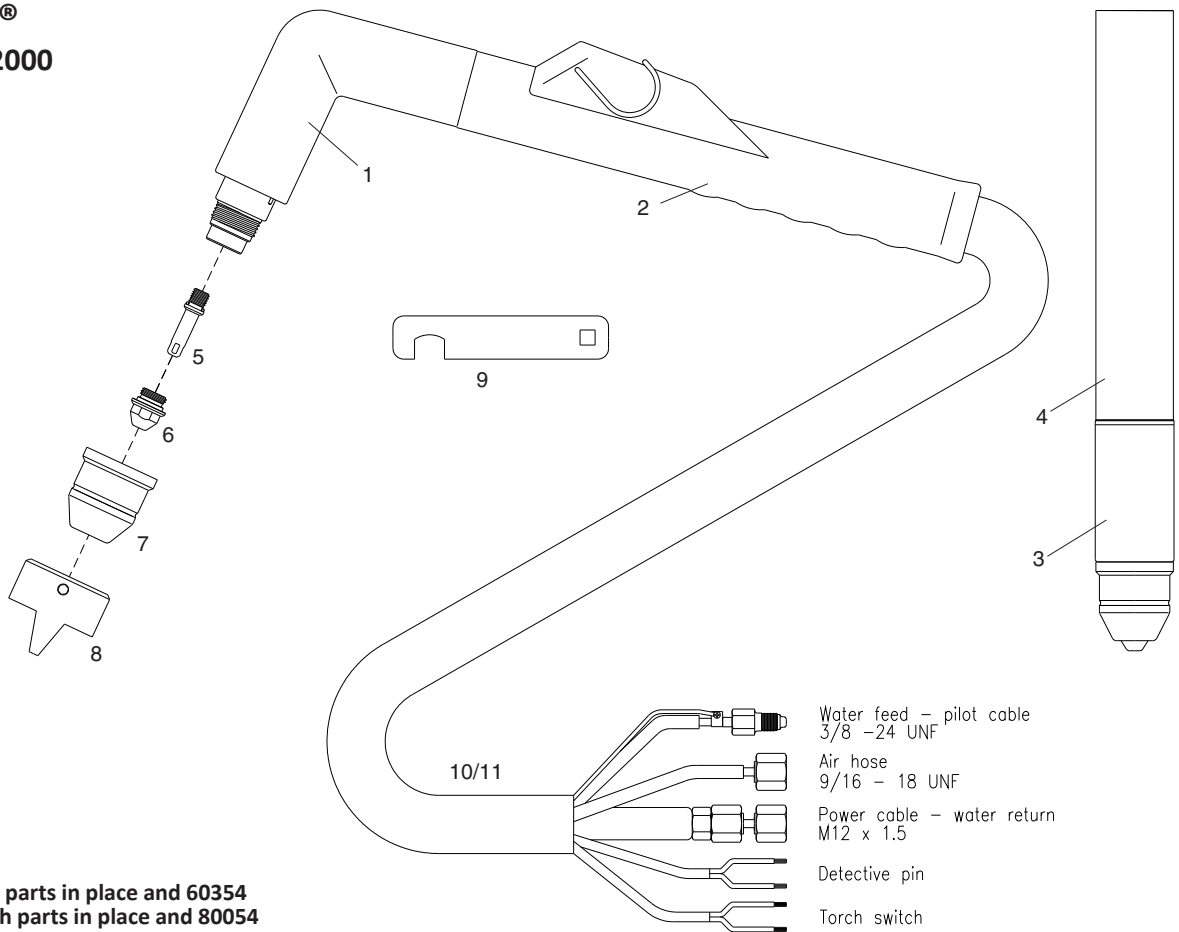

(*) with parts in place and 60354
 (**) with parts in place and 80054

No.	Ref.	Code	Description	Pkg.	No.	Ref.	Code	Description	Pkg.
		07820	Hand torch 6m	1	6	H839K01	51271	Tip ø 1.3 80A	10
		07830	Hand torch 12m	1		H839G03	51272	Tip ø 1.6 120A	10
		07840	Machine torch 6m	1	7		80054	Shield cap Ceramic	10
		07850	Machine torch 12m	1			60354	Shield cap Fiberglass	10
1		07801	Hand torch head (*) w/handle	1	8		60374	Double pointed spacer	6
2		04280/C	Handgrip w/microswitch	1	9		07800.57	Wrench for tip & electrode	1
3		07811	Machine torch head (**) w/handle	1	10		07880	Cable 6m Hand torch	1
4		07215	Machine handle	1			07885	Cable 12m Hand torch	1
5	H839M00	52750/OR	Electrode with O-Ring	10	11		07890	Cable 6m Machine torch	1
6	H839K03	51269	Tip ø 0.8 30A	10			07895	Cable 12m Machine torch	1
	H839K02	51270	Tip ø 1.0 50A	10					