

KJELLBERG®

PA-S47CNC® - FineFocus 450®

PB-S20W/WH® PB-S25W/WH®

PB-S40W/WH® PB-S45W/WH®

PB-S45W/WH-1®

PZ-S45W®

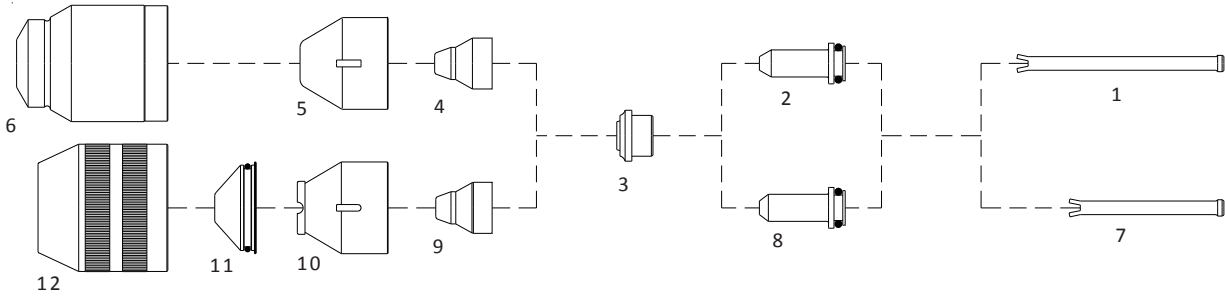

| No. | Ref. | Code | Description | Pkg. | No. | Ref. | Code | Description | Pkg. |
|-----|------------------|--------|--------------------------|------|-----|------------------|----------|---------------------------------------|------|
| 1 | .11.832.201.152 | 60366B | Cooling tube W901 | 1 | 7 | .11.828.001.152 | 60366 | Cooling tube | 1 |
| 2 | .11.828.001.3001 | 52705 | Electrode Kb, Air, XF | 5 | 8 | .11.834.321.3001 | 52708AG | Electrode Kb - XI Silver | 5 |
| 3 | .11.828.001.153 | 60066 | Swirl ring Max Life Z111 | 2 | 9 | .11.834.321.410 | 51656.10 | Nozzle Lle - XI ø 1.0, O ₂ | 5 |
| 4 | .11.828.203.410 | 51594 | Nozzle Lle ø 1.0 - Air | 5 | | .11.834.321.413 | 51657.13 | Nozzle Lde - XI ø 1.3, O ₂ | 5 |
| | .11.828.203.413 | 51595 | Nozzle Lde ø 1.3 - Air | 5 | | .11.834.321.414 | 51657.14 | Nozzle Lee - XI ø 1.4, O ₂ | 5 |
| | .11.828.203.414 | 51596 | Nozzle Lee ø 1.4 - Air | 5 | 10 | .11.832.201.160 | 60570 | Retaining cap W3030 | 1 |
| 5 | .11.830.301.151 | 60357 | Retaining cap ø 9.6 | 5 | 11 | .11.832.201.1571 | 60562 | Shield ø 4.0 W4140 | 5 |
| 6 | .11.828.101.160 | 60359 | Shield cap | 1 | | .11.832.201.1561 | 60562.30 | Shield ø 3.0 W4130 | 5 |
| | | | | | 12 | .11.832.201.081 | 60560 | Shield cap W501 | 5 |

 **Notes**
