

Replacement parts suitable for:

HYPERTHERM®

POWERMAX 1000® T60/T60M®
POWERMAX 1250® T80/T80M®
POWERMAX 1650® T100/T100M®
POWERMAX 1100® RT80/RT80M®
RT60/RT60M®

* while stocks last

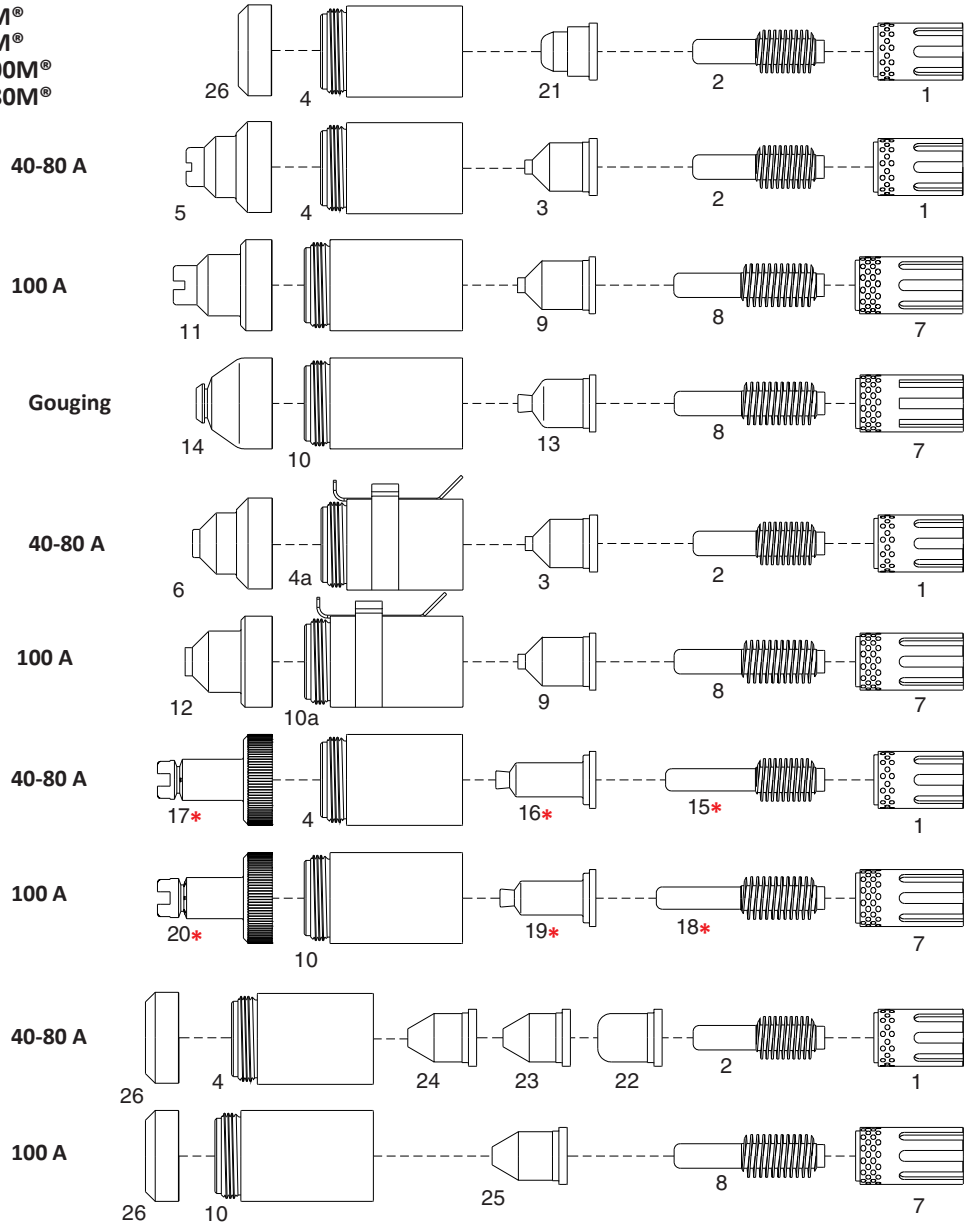

No.	Ref.	Code	Description	No.	Ref.	Code	Description
1	120925	60043	Swirl ring Max Life 40/80A	10a	220206	60307H	Retaining cap 100A OHMIC
	120925	60043E	Swirl ring 40/80A		220206	60307HV	Retaining cap 100A OHMIC "T.Q."
2	120926	52675	Electrode 40-80A	11	220065	51983/TD	Hand shield 100A
	120926	52675BM	Electrode 40-80A BiMetal	12	220047	51984/TD	Machine shield 100A
3	120932	51405.10	Tip 40A shielded	13		51409.24	Tip 125A Gouging
	120931	51405.12	Tip 60A shielded	14		51989G	Shield Gouging
	120927	51405.14	Tip 80A shielded	15*		52675L	Extended electrode 40-80A
4	120928	60304	Retaining cap 40/80A	16*		51405L.10	Extended tip 40A shielded
	120928	60304V	Retaining cap 40/80A "Top Quality"			51405L.12	Extended tip 60A shielded
4a	220061	60304H	Retaining cap 40/80A OHMIC			51405L.14	Extended tip 80A shielded
	220061	60304HV	Retaining cap 40/80A OHMIC "T.Q."	17*		60505L	Extended shield 40-80A
5	120929	51981/TD	Hand shield 40/80A	18*		52676L	Extended electrode 100A
6	120930	51982/TD	Machine shield 40/80A	19*		51406L.15	Extended tip 100A shielded
7	220051	60044	Swirl ring Max Life 100A	20*		51983L	Extended shield 100A
	220051	60044E	Swirl ring 100A	21	220329	51407	Tip 30-50A Precision Cut
8	220037	52676	Electrode 100A	22	220006	51402	Tip 40A unshielded
	220037	52676BM	Electrode 100A BiMetal	23	220007	51403	Tip 60A unshielded
9	220011	51406	Tip 100A shielded	24	120980	51404	Tip 80A unshielded
10	220048	60307	Retaining cap 100A	25	220064	51408	Tip 100A unshielded
	220048	60307V	Retaining cap 100A "Top Quality"	26	120979	51939	Deflector

HYPERTHERM®

POWERMAX 30® AIR® - AIR T30

POWERMAX 30® - T30v
POWERMAX 45® - T45v / T45m

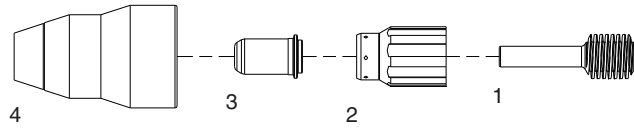
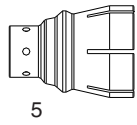

No.	Ref.	Code	Description	No.	Ref.	Code	Description
1	220478	52573	Electrode	4	220483	60302	Retaining Cap
2	220479	60009	Swirl ring Max Life	---	-----	-----	-----
3	220480	51218	Tip, 30A	5	420399	51954	Deflector (T30 only)

HYPERTHERM®

POWERMAX 45® T45v® T45m®

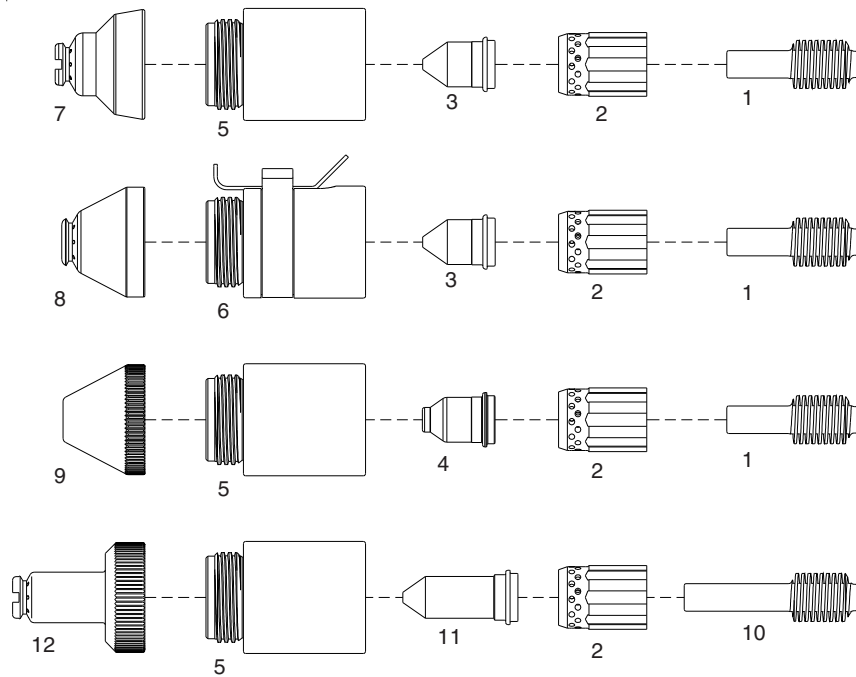

No.	Ref.	Code	Description	No.	Ref.	Code	Description
1	220669	52574	Electrode	7	220674TD	51923	Hand shield
2	220670	60041	Swirl ring Max Life	8	220673TD	51924	Machine shield
	220670	60041E	Swirl ring	9		51924G	Gouging shield
3	220671TD	51206	Tip 45A	10		52574L	Extended Electrode
4		51206G	Tip 45A Gouging	11		51206L	Extended Tip 45A
5	220713	60305	Retaining cap	12		51923L	Extended Hand shield
6	220719	60305H	Retaining cap OHMIC				

Patent Pending

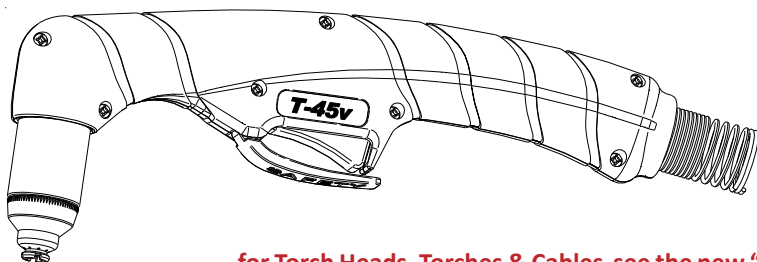

Patent Pending

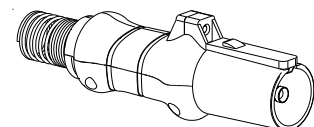

for Torch Heads, Torches & Cables see the new "RPT Catalog"

Replacement parts suitable for:

HYPERTHERM®

POWERMAX 45XP®

POWERMAX 85® H85® M85®

POWERMAX 65® H65® M65®

POWERMAX 1000/1250/1650® HRT® MRT® Retrofit torch

POWERMAX 105® H105® M105®

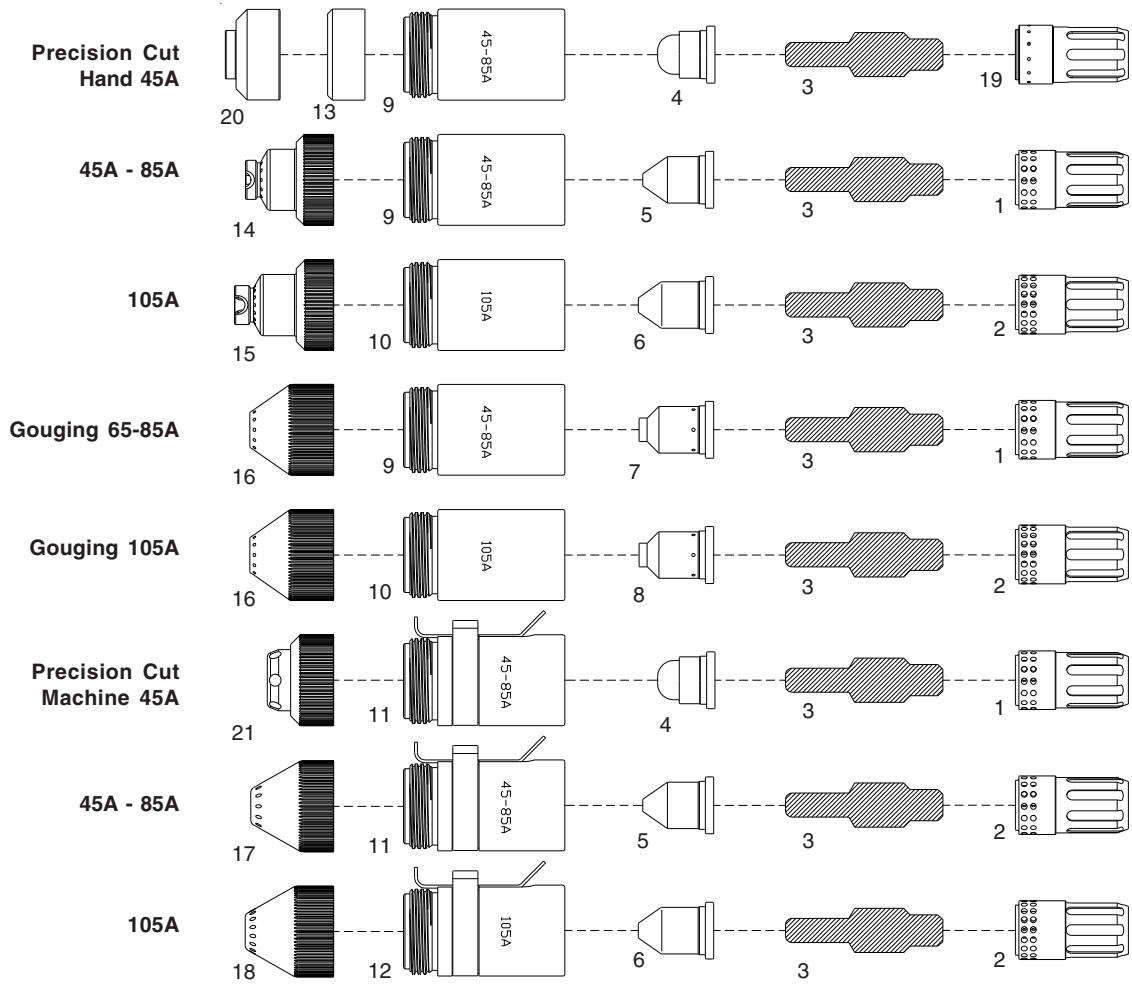

No.	Ref.	Code	Description	No.	Ref.	Code	Description
1	220857	60042	Swirl ring 45-85A Max Life	10	220854/105	60309B	Retaining cap 105A
	220857	60042E	Swirl ring 45-85A		220854/105	60309BV	Retaining cap 105A "Top Quality"
2	220994	60040	Swirl ring 105A Max Life	11	220953/85	60309HA	Retaining cap 45-85A OHMIC
	220994	60040E	Swirl ring 105A	12	220953/105	60309HB	Retaining cap 105A OHMIC
3	220842	N/A	Electrode 45-105A	13	220955	51928	Deflector
4	220930	51415	Tip 45A Precision Cut	14	220818TD	51921	Hand shield 45-85A
5	220941TD	51416	Tip 45A (for use with item #9 or 11)	15	220992TD	51926	Hand shield 105A
	220819TD	51417	Tip 65A (for use with item #9 or 11)	16		51927G	Gouging shield
	220816TD	51418	Tip 85A (for use with item #9 or 11)	17	220817TD	51922	Machine shield 45-85A
6	220990TD	51419	Tip 105A (for use with item #10 or 12)	18	220993TD	51927	Machine shield 105A
7		51417G	Tip 65-85A Gouging (for use with item #9)	19	220947	60032	Swirl ring, 45A, Precision Cut, Hand
8		51418G	Tip 105A Gouging (for use with item #10)	20	220931	51931	Deflector, 45A, Precision Cut, Hand
9	220854/85	60309A	Retaining cap 45-85A	21	220948	51929	Deflector, 45A, Precision Cut, Machine
	220854/85	60309AV	Retaining cap 45-85A "Top Quality"				

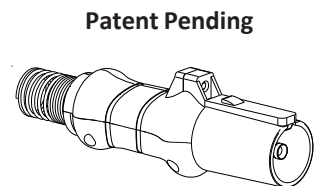
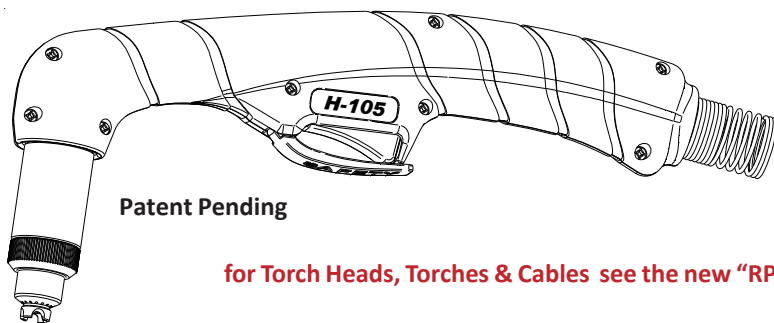

for Torch Heads, Torches & Cables see the new "RPT Catalog"

HYPERTHERM®
POWERMAX 125® H125® M125®

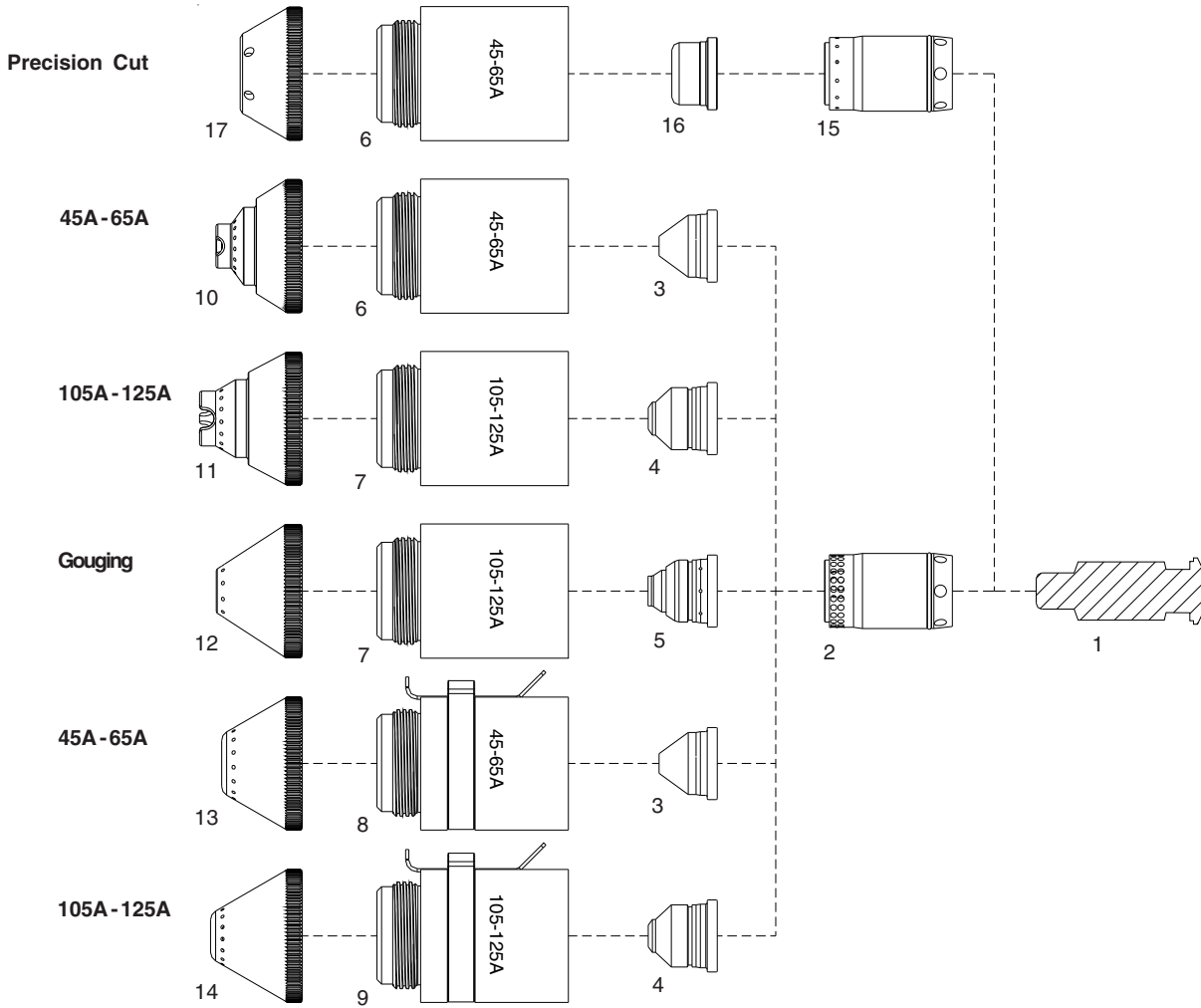

No.	Ref.	Code	Description	No.	Ref.	Code	Description
1	220971	N/A	Electrode 35A - 125A	9	420156/125	60311HB	Retaining cap OHMIC 105-125A
2	220997	60039	Swirl ring 35A - 125A	10	420172TD	51916	Shield Cap, Hand, 35-65A
3	420158TD	51420	Tip 45A (for use with item #6 or 8)	11	420000TD	51917	Shield Cap, Hand, 105-125A
	420169TD	51421	Tip 65A (for use with item #6 or 8)	12		51919G	Shield Cap, Gouging 105-125A
4	220975TD	51424	Tip 105-125A (for use with item #7 or 9)	13	420168TD	51918	Shield Cap, Machine, 35-65A
		51424G	Tip 105-125A Gouging (for use with item 7)	14	220976TD	51919	Shield Cap, Machine, 105-125A
6	220977/65	60311A	Retaining cap 35-65A	15	420159	60033	Swirl Ring, Precision Cut, (Hand Cutting)
7	220977/125	60311B	Retaining cap 105-125A	16	420151	51428	Tip, 30-45A, Precision Cut
8	420156/65	60311HA	Retaining cap OHMIC 35-65A	17	420152	51915	Deflector, Precision Cut

Patent Pending

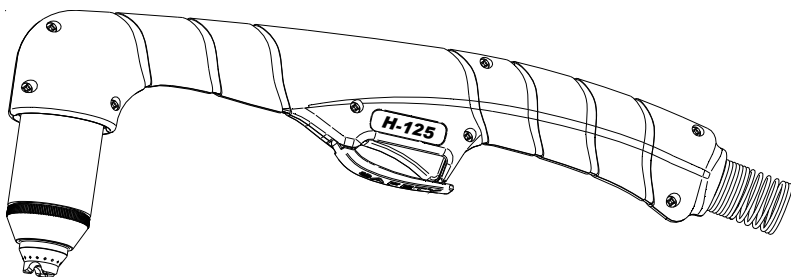

Patent Pending

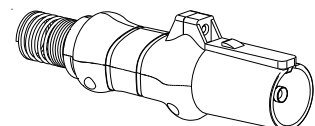

for Torch Heads, Torches & Cables see the new "RPT Catalog"

Replacement parts suitable for:

HYPERTHERM®
MAX 20®
PAC110®

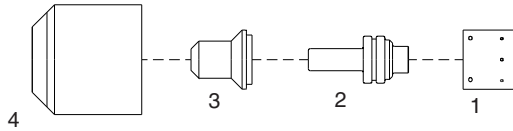

while stocks last

No.	Ref.	Code	Description	No.	Ref.	Code	Description
1	020239	60035	Swirl ring	3	020381	51216	Extended tip ϕ 0,73 - .029
2	020382	52571	Extended electrode	4	020218	60300	Retaining cap

HYPERTHERM®
POWERMAX 350® PAC110®
POWERMAX 380® PAC110T®

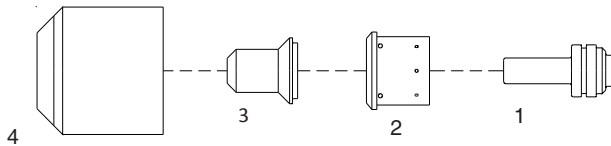

while stocks last

No.	Ref.	Code	Description	No.	Ref.	Code	Description
1	020382	52571	Extended electrode	3	120504	51217	Extended tip ϕ 0,81 - .032
2	220013	60037	Swirl ring	4	220016	60300	Retaining cap

HYPERTHERM®
POWERMAX 600®
PAC123T/M®

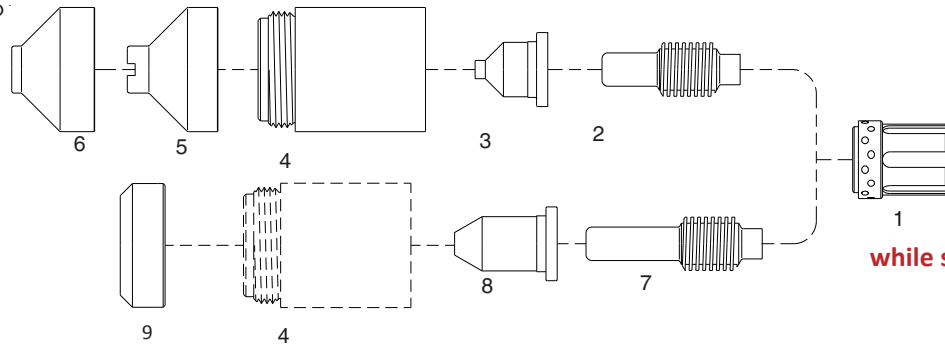

while stocks last

No.	Ref.	Code	Description	No.	Ref.	Code	Description
1	120576	60047	Swirl ring	6	120827	51979/TD	Machine shield
2	120573	52575	Electrode	7	120574	52576	Extended electrode
3	120826	51214	Tip 40A	8	120606	51208	Extended tip 35A
4	120600	60316	Retaining cap	9	120303	51987/TD	Deflector
5	120828	51978/TD	Hand shield				

HYPERTHERM®
POWERMAX 800®
MAX 42/43®/40CS®
PAC121PT/M®
PAC121TS/M®

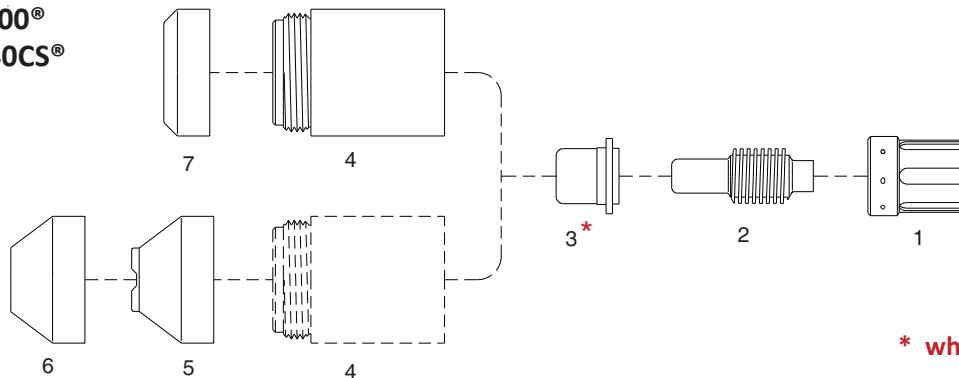

* while stocks last

No.	Ref.	Code	Description	No.	Ref.	Code	Description
1	020361	60046	Swirl ring	4	120301	60316	Retaining cap
2	120573	52575	Electrode (replaces 020351)	5	120283	51985/TD	Hand shield
3*	120438	51204	Tip 40A	6	120326	51986/TD	Machine shield
	120282	51201	Tip 50A	7	120303	51987/TD	Deflector

HYPERTHERM®
POWERMAX 900®
PAC125T/M®

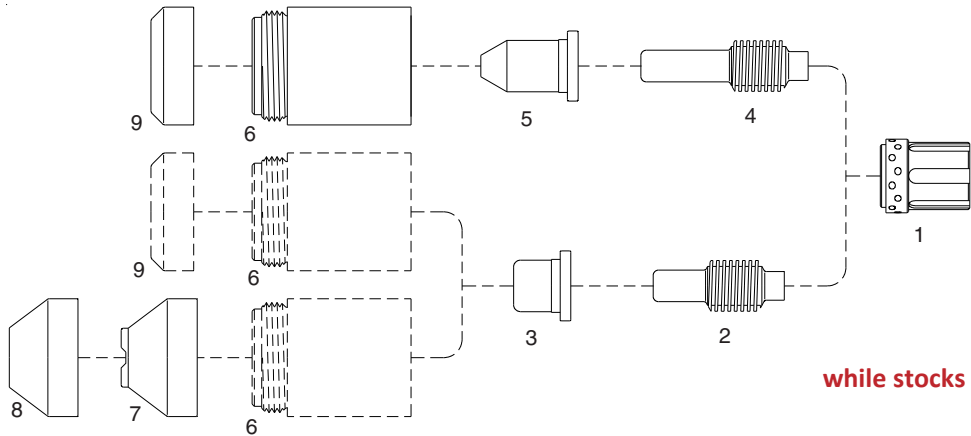

while stocks last

No.	Ref.	Code	Description	No.	Ref.	Code	Description
1	120576	60047	Swirl ring	120578	51209		Extended tip 55A pipe saddle
2	120573	52575	Electrode	6	120600	60316	Retaining cap
3	120577	51207	Tip 55A shielded	7	120601	51985/TD	Hand shield
4	120574	52576	Extended electrode	8	120602	51986/TD	Machine shield
5	120606	51208	Extended tip 35A	9	120303	51987/TD	Deflector

HYPERTHERM®
MAX 40®
PAC140®
HT40®

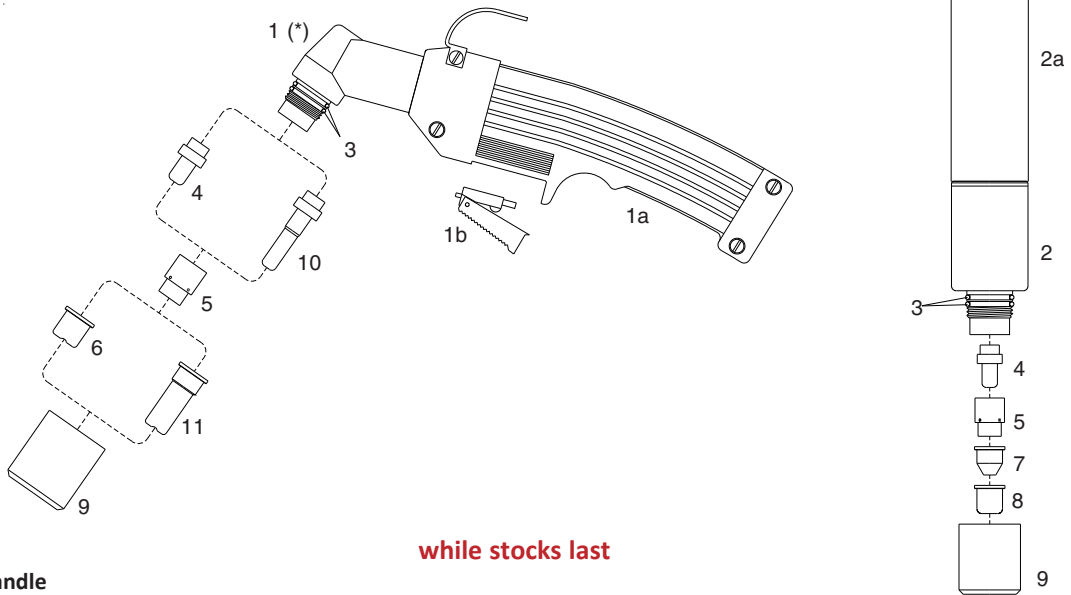

while stocks last

(*) complete with handle

No.	Ref.	Code	Description	No.	Ref.	Code	Description
	057112	07320	Hand torch 25'	3	026016	07300.60	O-Ring
	057113	07330	Hand torch 50'	4	020103	52512/L	Electrode
		07340	Machine torch 25'	5	020101	60001	Swirl ring
		07350	Machine torch 50'	6	020115	51100	Tip, hand torch
1	057114	07300	Hand torch body (*)	7	020131	51098	Pipe saddle tip, machine torch
1a		07301	Handgrip with switch	8	020102	51099	Tip, machine torch
1b		07301.20	Switch	9	020104	60301	Retaining cap
2	020114	07310	Machine torch body	10	020467	52513/L	Extended electrode
2a	020206	07315	Machine handle	11	020466	51102	Extended tip

Replacement parts suitable for:

HYPERTHERM®
MAX 80/100®
PAC130®

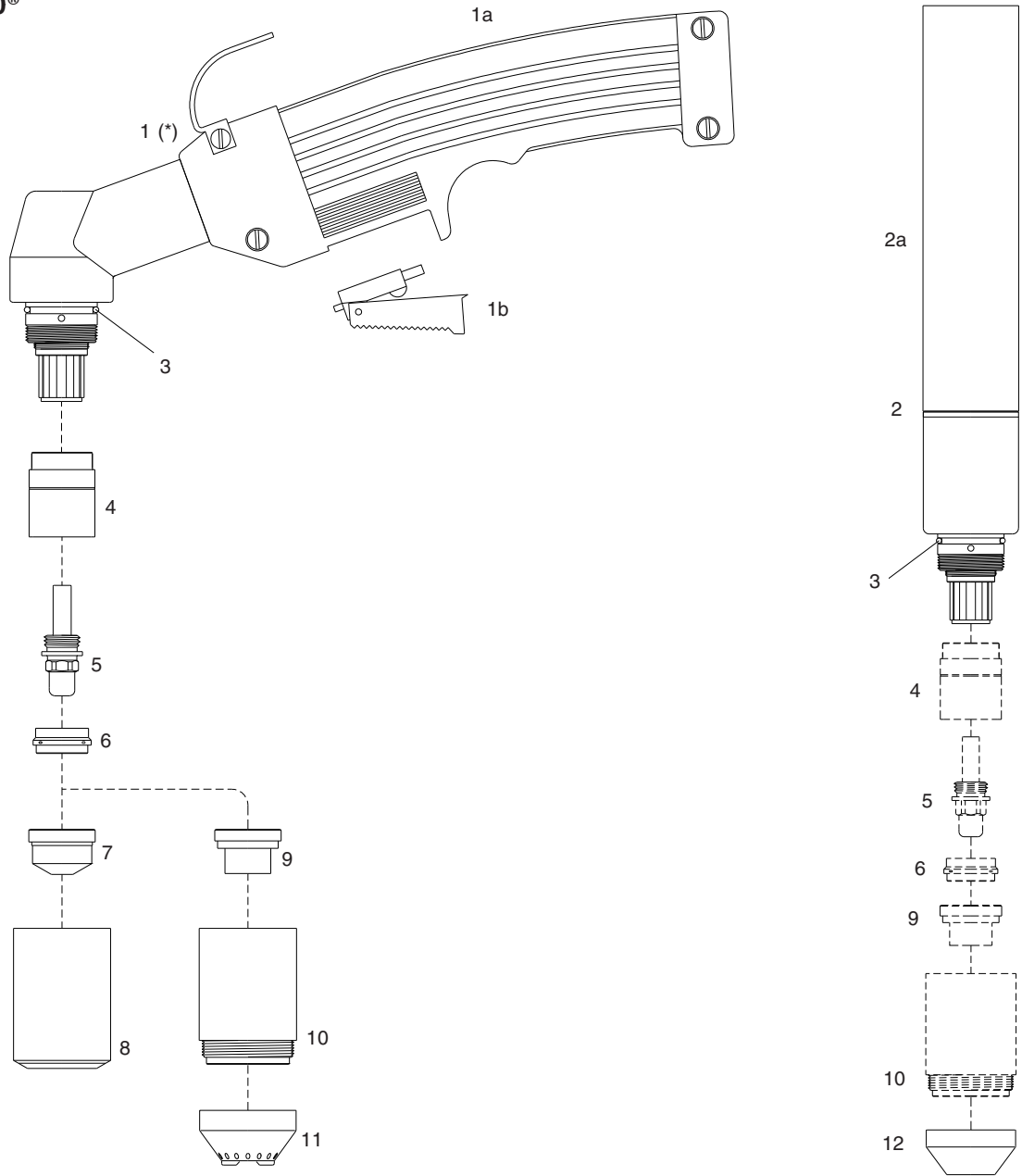

(*) complete with handle

No.	Ref.	Code	Description	No.	Ref.	Code	Description
	059076	07420	Hand torch 25'	6	020194	60010	Swirl ring
	059077	07430	Hand torch 50'	7	020203	51120	Tip 40A ϕ 1,0 - .038
		07440	Machine torch 25'		020345	51121	Tip 80A ϕ 1,3 - .052
		07450	Machine torch 50'		020195	51122	Tip 100A ϕ 1,5 - .059
1	020189	07400	Hand torch body (*)	8	020184	60310	Retaining cap
1a		07301	Handgrip with switch	9	020397	51400	Contact tip 80A ϕ 1,3 - .052
1b		07301.20	Switch		020337	51401	Contact tip 100A ϕ 1,5 - .059
2	020201	07410	Machine torch body	10		60340/TD	Contact retaining cap
2a	020245	07215	Machine handle			020336	Contact retaining cap Max Life
3	026018	06000.60	O-ring	11	020335	51930/TD	Spacer, hand contact cutting
4		60080	Front insulator	12	020334	51935/TD	Machine shield cap
5	120433	52520/TD	Electrode (replaces 020191)				