

Replacement parts suitable for DURMA®

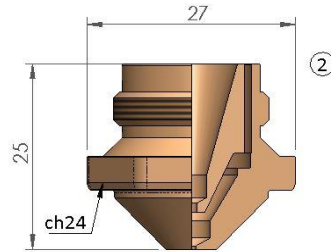
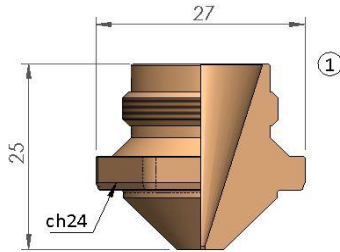

POS	AZ CODE	ORIGINAL CODE	DESCRIPTION	unit price	10 pack price
1	261003		DURMA® NOZZLE Ø 1.2		
	261003V		DURMA® NOZZLE Ø 1.2		
	261004		DURMA® NOZZLE Ø 1.5		
	261004V		DURMA® NOZZLE Ø 1.5		
	261005		DURMA® NOZZLE Ø 1.8		
	261005V		DURMA® NOZZLE Ø 1.8		
	261006		DURMA® NOZZLE Ø 2.0		
	261006V		DURMA® NOZZLE Ø 2.0		
	261007		DURMA® NOZZLE Ø 2.5		
	261007V		DURMA® NOZZLE Ø 2.5		
	261008		DURMA® NOZZLE Ø 3.0		
	261008V		DURMA® NOZZLE Ø 3.0		
	261010		DURMA® NOZZLE Ø 4.0		
	261010V		DURMA® NOZZLE Ø 4.0		
2	261013		DURMA® DOUBLE NOZZLE Ø 1.2		
	261013V		DURMA® DOUBLE NOZZLE Ø 1.2		
	261014		DURMA® DOUBLE NOZZLE Ø 1.5		
	261014V		DURMA® DOUBLE NOZZLE Ø 1.5		
	261015		DURMA® DOUBLE NOZZLE Ø 1.8		
	261015V		DURMA® DOUBLE NOZZLE Ø 1.8		
	261016		DURMA® DOUBLE NOZZLE Ø 2.0		
	261016V		DURMA® DOUBLE NOZZLE Ø 2.0		
	261017		DURMA® DOUBLE NOZZLE Ø 2.5		
	261017V		DURMA® DOUBLE NOZZLE Ø 2.5		
	261018		DURMA® DOUBLE NOZZLE Ø 3.0		
	261018V		DURMA® DOUBLE NOZZLE Ø 3.0		
	261019		DURMA® DOUBLE NOZZLE Ø 3.5		
	261019V		DURMA® DOUBLE NOZZLE Ø 3.5		
	261020		DURMA® DOUBLENOZZLE Ø 4.0		
	261020V		DURMA® DOUBLE NOZZLE Ø 4.0		

San Giorgio Plasma Parts srls is not affiliated with the named manufacturers. Reference to machines, parts, descriptions, and model numbers are for convenience in verifying compatibility only. All parts are made by or for San Giorgio Plasma Parts srls and are not made by the reference manufactures (unless expressly indicated). All other trademarks are the properties of their respective owners."